

Uwchlan Township EAC and Project: “Heart of Uwchlan”



TO ENHANCE UWCHLAN TOWNSHIP CAMPUS AND SURROUNDS TO
PROMOTE FAMILY-FRIENDLY ENVIRONMENT
TO SUPPORT #SUSTAINABLEUWCHLAN GOALS
TO EDUCATE THE PUBLIC ON SUSTAINABLE PRACTICES

TONI GORKIN
TGORKIN@GMAIL.COM
APRIL 2021

#Sustainable Uwchlan



- Background

- 2018-2019: Uwchlan Township defined #SustainableUwchlan initiatives
 - **BOS established Environmental Advisory Council (EAC)**
 - Voted to support **Ready 100% - 100% renewable energy by 2050** and to promote reduction in use of single-use plastics
 - EAC held first of community outreach events, including promotion of gardening with native plants, education on spotted lantern fly, etc.
 - **10-Year Comprehensive Plan updated – EAC provided input on sustainability** concerns; plan became task setter for the EAC
- Community interest in sustainable practices is on the rise: native plants, support of pollinators and butterflies, composting, control of invasive insects, storm water management, “the environment”
- Project “Heart of Uwchlan” developed as part of Toni Gorkin’s Pennsylvania Master Naturalist training was approved by the EAC

“Heart of Uwchlan” Goals



- Improve the natural environment of the township office grounds – by introducing native plants to the over-mowed park
- Educate the public on sustainable practices through example
- Educate the public through webpage, handouts, media, etc. – including potential Developers
- Involve families and public to enjoy nature – through Learning Trail and Passport
- Involve all levels of community, including youth, students, groups
- Support the wider goals of the EAC to promote sustainability

“Heart of Uwchlan” Milkweed Garden



- **Milkweed Garden – Monarch Way Station**
 - Located outside meeting room – to support Monarch butterflies and other pollinators and help manage rainfall overflow
 - “Planting Milkweed Seeds” Workshop held fall 2019; held again in fall 2020 via recording
 - Seeds prepared through winter “stratification to plant in May
 - We had caterpillars and butterflies
 - Generated a lot of interest
 - A Station on the Learning Stations trail

“Heart of Uwchlan” Milkweed Garden



- Milkweed Garden Planted May - June 2020
 - Volunteers planted, watered the garden
 - Plants bloomed well
 - Rain barrel incorporated into the garden
 - Handouts with plant suggestions developed and posted to Township website
 - Visibility to the public, lots of interest



“Heart of Uwchlan” Riparian Border



- Riparian Border – Streamside Garden
- May/June Planted “lasagna garden” area with native plants that:
 - Support native pollinators and butterflies from spring into fall
 - Provide attractive color in various seasons spring through fall
 - Tolerate the wetness of the area
 - Provide food for resident and migrating birds
 - **Serve as examples and educational resources for township residents**
- Suggested Plant Lists Developed
 - Posted to EAC Internet Page
- Educational Signs posted



“Heart of Uwchlan” Learning Stations

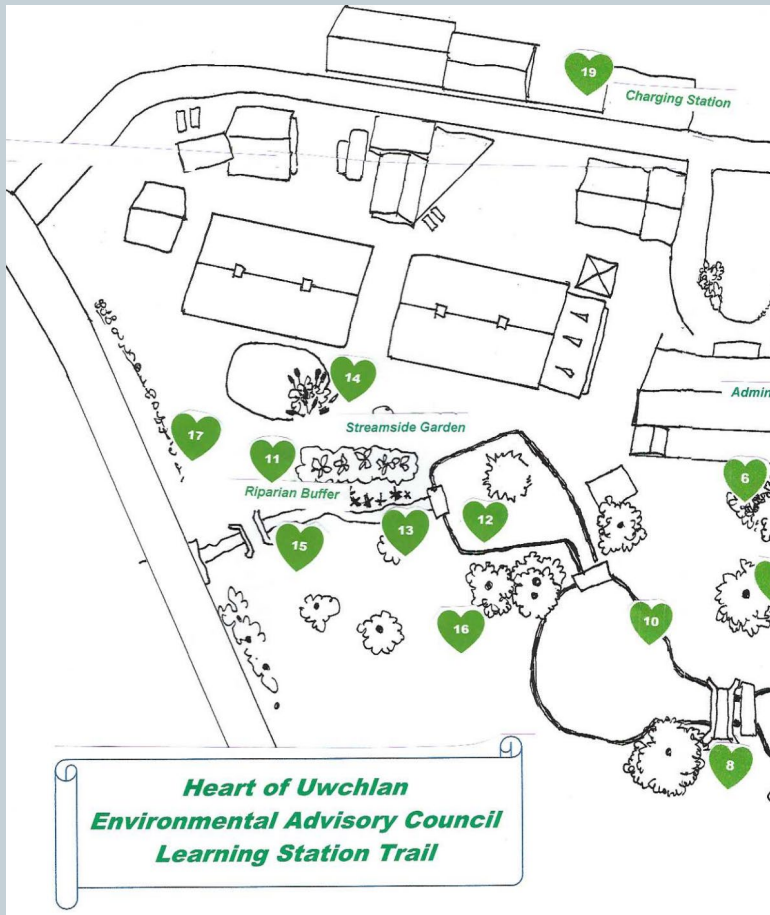

- Family Trail of over 15 “Learning Stations” within the confines of the Uwchlan Township campus.
 - Allow visitors to travel a series of learning opportunities related to #SustainableUwchlan and EAC initiatives
-
- Audience: individuals, families with children, school groups, community organizations
 - Stations would support EAC community outreach events



“Heart of Uwchlan” Learning Stations

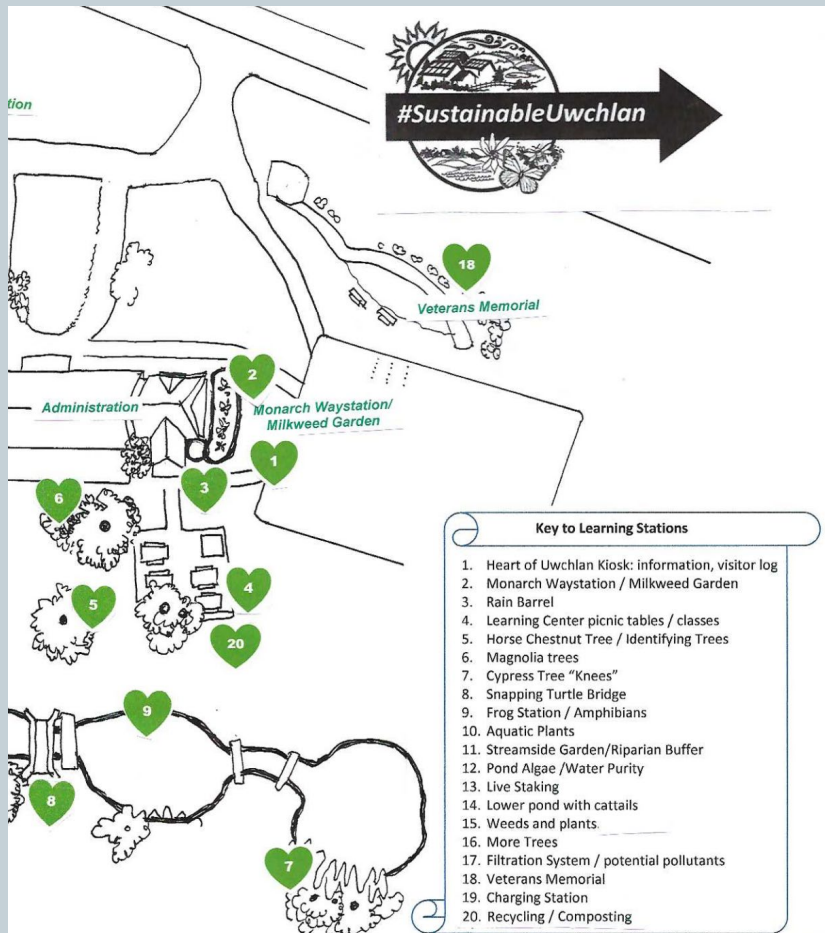

- Learning Stations Handbook
 - Teaching Information for each station
 - Posted to website; copy in Admin Lobby
- Handouts
 - Lists of Suggested Plants
- Backpack (future)
 - Learning tools, nature guides
- Children could complete the #SustainableUwchlan Passport
- Stations/events could be coordinated with school projects, Scouting merit badges
- Remote/outside activities within Covid requirements

Handbook, Passport, Handouts, Webpage

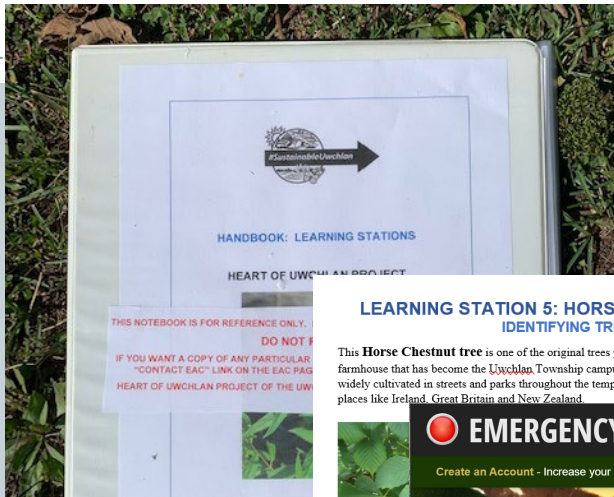

LEARNING STATION 5: HORSE CHESTNUT TREE IDENTIFYING TREES

This **Horse Chestnut tree** is one of the original trees planted in the grounds of the historic farmhouse that has become the Uwchlan Township campus. It is not native to the U.S., and is widely cultivated in streets and parks throughout the temperate world, especially successful in places like Ireland, Great Britain and New Zealand.

EMERGENCY ALERT

COVID-19 Update: Uwchlan Township Offices Remain Closed Until Further Notice

[Read On...](#)

Create an Account - Increase your productivity, customize your experience, and engage in information you care about.

[Sign In](#)

Learnings:

Tree identification terminology:

- Deciduous** – the tree drops its leaves in the fall, rather than **evergreen** or retaining leaves or needles through the winter.
- Opposite** – the leaves are arranged in pairs on the branch, opposite each other, rather than **alternate**, or one then another down the branch.
- Palmate compound leaf** – a leaf that is composed of several leaflets and the leaflets are arranged like a hand, from a single center point, rather than **pinnate** or along a stem.
- Petiole** – the “stem” that connects the tree to the branch.
- Leaf scar** – the scar left on the branch when the tree drops its leaves in the fall
- Panicle** – a loose branching cluster of flowers

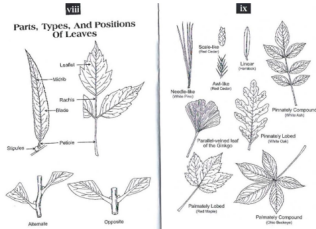

Imported vs native trees:

- Despite similar names, the Horse Chestnut and the American Chestnut are not closely related.

Impact of Invasive Diseases:

- The impact of invasive diseases: the native American Chestnut was a major tree in America, economically important and key in our landscapes until the blight killed them early in this century.

Native Planting Resources

[Trash & Recycling](#)

[Let us Know](#)

[Notify Me®](#)

[Online Payments](#)

[Home](#) > [Government](#) > [Boards & Commissions](#) > [Environmental Advisory Council](#) > [Heart of Uwchlan Project](#)

Heart of Uwchlan



HEART OF UWCHLAN PROJECT

Uwchlan Township Environmental Advisory Council Plants Monarch Waystation Milkweed Garden for Heart of Uwchlan

Members of Uwchlan Township's Environmental Advisory Council (EAC) planted a milkweed garden near the Township's meeting hall on Ship Road in Exton on May 29 and 30 to establish a Monarch Butterfly Waystation. The planting was done by Laura Obenski, EAC Chairperson Alexa Manning, and Toni Gorkin, project organizer. The garden is part of the EAC's Project "Heart of Uwchlan," in alignment with the Township's #SustainableUwchlan focus. The project's purpose is to introduce native plants to the campus to increase biodiversity and support pollinators so essential to a sound area ecosystem. The project's goals also include environmental education by establishing learning stations to educate township families about nature and sustainable practices to enhance the environment.

Documents and Resources

[Learning Stations Handbook](#)

[Best Plants for Bees](#)

[Best Plants for Birds](#)

[Best Plants for Butterflies](#)

[Native Plants by Bloom Time](#)

[Heart of Uwchlan Pollinator Garden Plant Suggestions - Perennials](#)

[Heart of Uwchlan Pollinator Garden Plant Suggestions - Shrubs](#)

[Monarch Waystation Milkweed Garden Plant List](#)

[Planting Milkweed Seeds](#)

FLY GARDEN PLANT LIST Heart of Uwchlan Garden

Common Milkweed (*Asclepias syriaca*)

Blooms June-August - Likes Dry Soil, Sun

A native perennial. The monarch butterfly deposits its eggs on the milkweed, the caterpillars feed on the leaves. Plants grow to 2-4 feet high, long, oblong leaves grow to about eight inches long. The stems and leaves bleed a milky sap when cut. Fragrant clusters of pink-purple flowers, seed pods two to four inches long split when ripe to cast many fine seeds to the wind.

Swamp Milkweed (*Asclepias incarnata*)

Blooms June-July, Likes Sun, Damp Location

Another Monarch host plant. Leaves are narrow, tapering. Pink flowers. Narrow pods. Good in wet pollinator gardens, rain gardens, pond edges, and monarch habitat plantings. Bright pink flowers. Can get tall (3-4').

Whorled Milkweed (*Asclepias verticillata*)

Blooms July-September - Likes Sun

Most plant for monarch caterpillars that blooms later than other milkweeds. Clone forming and only one to two feet tall, it forms attractive drifts of plants. Narrow three to four-inch pods form in late summer as the leaves turn to yellow and orange providing interest well into autumn.

Butterfly Weed (*Asclepias tuberosa*)

Blooms June-August, Sun, Dry Location

Native in milkweed family that produce flat clusters of bright orange blossoms all summer long. Nectar- and pollen-rich flowers attract hummingbirds and hordes of butterflies, bees and other beneficial insects throughout the blooming season. Food plant for monarch caterpillars. It is about one to two feet tall, with glossy, lanceolate leaves that are arranged spirally up the length of the stem. The seed pods turn brown over time and add winter interest to the garden.

NOT TO BE CONFUSED with **Butterfly Bush** (*Buddleia davidii*), a fast-growing, deciduous shrub with spiked trusses that bloom from summer to autumn. While Butterfly Bush attracts butterflies, its pollen is inferior and the birds carry seeds, making it invasive.

Meadow Blazing Star (*Liatris ligulistylus*)

Blooms August-September - Likes Sun, Medium Soil

“Heart of Uwchlan” 2021



- Impact of Covid restrictions – township office closed
- Repeated Planting Milkweed Seeds Workshop – using recording. Lots of interest because of milkweed garden!!
- Third garden – prepared with lasagna gardening, stratifying seeds
- 2021:
 - Planting and maintenance of gardens
 - Rain Garden
 - Enhance Learning Trail



“Heart of Uwchlan” Strategies



- Resources and Strategies
 - Recruit volunteers as “Stewards”
 - Collaborate with PA Master Naturalists, Master Watershed Stewards, Master Gardeners
 - So far, **accrued over 200 volunteer hours at end of 2020**
 - Collaborate with Historic Commission and Parks and Recs Commission
 - Involve with school and youth organization programs – e.g., Downingtown East Tree-Plenish
- Constraints
 - **Covid restrictions** hinder recruiting volunteers and holding public events
 - Respect/support historical characteristics of the area, support the Veterans Memorial mood
 - Do not add volume or complexity to the work of the Public Works personnel
 - Supplement but do not interfere with the areas of the grounds devoted to police, infrastructure maintenance



EAC Outreach 2021: Virtual Education

- Virtual Education Sessions
 - April 13: Guess Who's Coming to Dinner: How and Why Create a buffet habitat for Pollinators
 - May 11: Bringing Nature Home: Replay Recording of Tallamy presentation
 - June 22: Suburban Lawn to Native Landscape: Connie Schmotzer
 - Ready for 100 and Energy Plan
 - Stormwater Management in our township



Guess Who's Coming to Dinner

How and why to create a year-round buffet and habitat for our pollinators
featuring Sharon Richardson



EAC Outreach and Collaboration

- Collaboration with Penn State Master Watershed Stewards
- Collaborate with other EAC's (Southern Chester County EAC meeting in March – shared interest in promoting native plants and reducing lawn)
- Developing “Developer’s Sustainability Resource Packet”
- Tree-Plenish with High School Environment Club



A DEVELOPER'S GUIDE TO ENVIRONMENTALLY SUSTAINABLE PRACTICES

In this day and age, the environment is emerging as a paramount concern not only to existing property owners, but to those planning new development. Public concern is rising about environmental degradation, especially around new development that may appear to reduce green space, add to energy usage, and impact the natural environment of our communities.

The opportunity exists for developers to adopt environmentally sustainable practices in their planning. A variety of best management practices (BMPs) are available that can help better manage habitat preservation and enhancement, address increasing volumes of stormwater, and meet demand for clean air, water, and natural beauty. Using these BMPs in planning can result in a development that has greater appeal to customers and increase financial benefit to the developer.

The purpose of this Guide is to provide information, as packet contents, references, and suggested sources, to assist the developer to explore this potential.

The Guide has the following sections:

Contents

INTRODUCTION TO SUSTAINABLE LANDSCAPING AND GREEN SPACE.....	1
GREEN PRACTICES FOR DEVELOPERS.....	2
MORE ABOUT TREES.....	4
MORE ABOUT NATIVE PLANTS.....	5
MANAGING PREVIOUSLY AGRICULTURAL LAND	7
USING GREEN STORMWATER INFRASTRUCTURE FEATURES.....	8
HANDOUTS IN THIS PACKAGE.....	9

EAC: Not Just “Heart of Uwchlan”



- While “Heart of Uwchlan” project gave visibility to promoting sustainability, other EAC subcommittees active too:
- Ready for 100 – Clean Energy Transition Plan
- Through its input to 10-Year Comprehensive Plan, EAC now has direction based on the Plan
- Providing input to BOS on Sustainability issues
- Input to Planning Commission and potential development projects
- Reduce-Reuse-Recycle education and projects, Community Cleanup
- Stormwater Management